

Insulated architectural wall façade panel systems - KS1000 AWP

Available in 3 profiles Micro-Rib (MR), Mini-Rib (MM) and Euro-Box (EB)

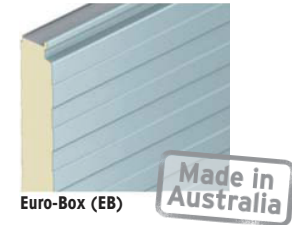
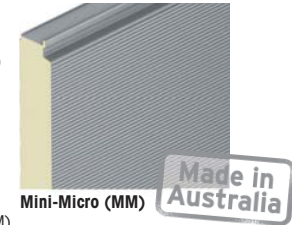
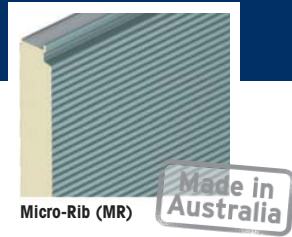
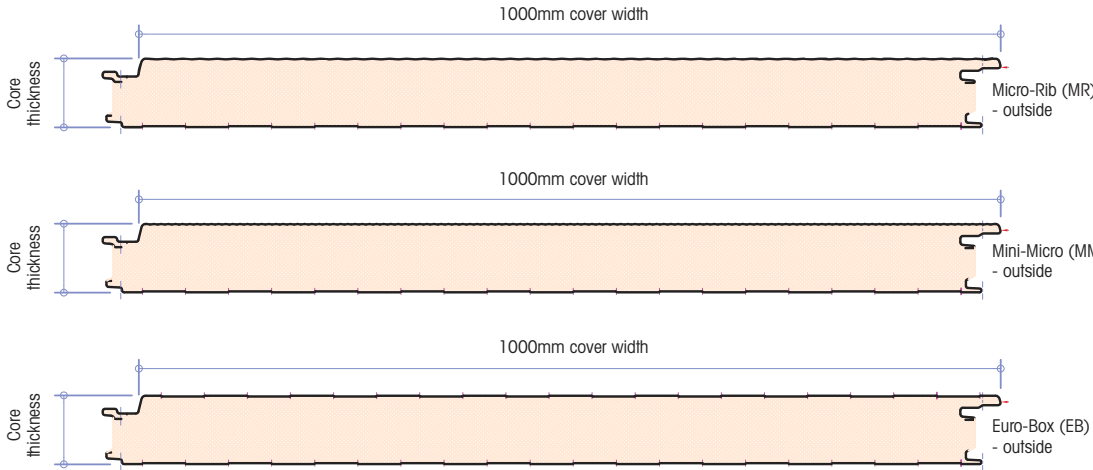

Core thickness (mm)	50	80
R-Value (m ² K/W)	2.65	4.15
Weight kg/m ² 0.5/0.4 steel	11.2	12.4

Deflection Ratio

Pressure = Span/100

Suction = Span/100

Unfactored Load/Span Table (Use calculated design windload values unfactored)

SPAN CONDITION	Core Thickness (mm)	LoadType	Uniformly Distributed Loads (kPa)																
			Span L in Metres																
			2.2	2.4	2.6	2.8	3.0	3.2	3.4	3.6	3.8	4.0	4.2	4.4	4.8	5.2	5.6	6.0	
SINGLE SPAN Outer Sheet 0.5mm steel Inner Sheet 0.4mm steel	50	Pressure	2.19	1.86	1.53	1.31	1.09	0.94	0.79	0.69	0.59	-	-	-	-	-	-	-	-
		Suction	1.83	1.53	1.22	1.03	0.83	0.69	0.54	0.44	0.33	-	-	-	-	-	-	-	-
	80	Pressure	4.85	4.20	3.64	3.18	2.78	2.44	2.15	1.90	1.69	1.50	1.34	1.19	0.96	0.78	-	-	-
		Suction	4.03	3.38	2.88	2.49	2.17	1.90	1.69	1.50	1.35	1.22	1.10	0.97	0.76	0.60	-	-	-
DOUBLE SPAN Outer Sheet 0.5mm steel Inner Sheet 0.4mm steel	50	Pressure	2.95	2.61	2.27	1.99	1.63	1.42	1.20	1.06	0.92	0.83	0.73	-	-	-	-	-	-
		Suction	2.45	2.10	1.75	1.54	1.32	1.17	1.00	0.92	0.82	0.75	0.67	-	-	-	-	-	-
	80	Pressure	4.85	4.44	4.10	3.81	3.23	2.71	2.30	1.97	1.71	1.50	1.33	1.18	0.96	0.79	0.67	0.57	-
		Suction	4.03	3.38	2.88	2.49	2.17	1.90	1.69	1.50	1.35	1.22	1.10	1.01	0.85	0.72	0.62	0.54	-

Vertical Joint Options

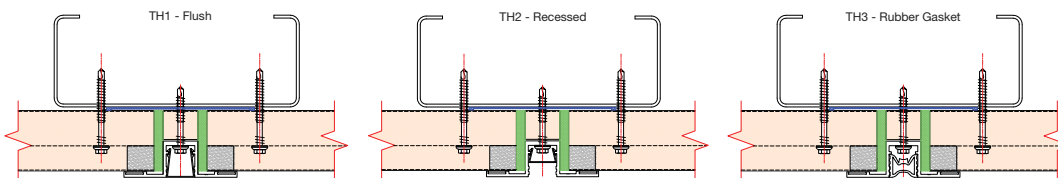

Note:
Number of fixings determined by
fastener calculation - contact
Technical Services for further
information.

For further technical information, please contact Kingspan Technical Services on (03) 358 7536

Kingspan Limited
Tel 03 358 7536 Fax 03 358 7539
Email infoNZ@kingspan.co.nz
www.kingspan.co.nz

Constructive
Thinking
Kingspan
Insulated Panels